

ARAPUNI DAM ENHANCEMENT WORK

December 2025 Newsletter.

Mercury 



Photo: Mercury Geospatial Team

The project site was busy during our jet grouting trial, from July to September 2025.

**KIA ORA,
MERI KIRIHIMETE**
HELLO, MERRY CHRISTMAS.

This is our fourth newsletter to update the community on our work at the Arapuni Hydro Dam. We've almost completed our early work programme, the data we've gathered in the past 18 months will help us kick into the main works in 2026.

We also want to take this opportunity to wish the Arapuni community a Merry Christmas and a Happy New Year!



Please forward this to anyone who might be interested. People can request to join our mailing list by sending a message to: project.arapuni@mercury.co.nz

PROJECT RECAP

The Arapuni Hydro Dam is safe for everyday use but work needs to be done to improve the left abutment (pictured below), to protect it from the risk of water seepage and internal erosion.

We started early works in 2024 and we are well into developing modern engineering options to reduce the risk of further seepage occurring. We expect to begin resetting the project site for the main works in March 2026.

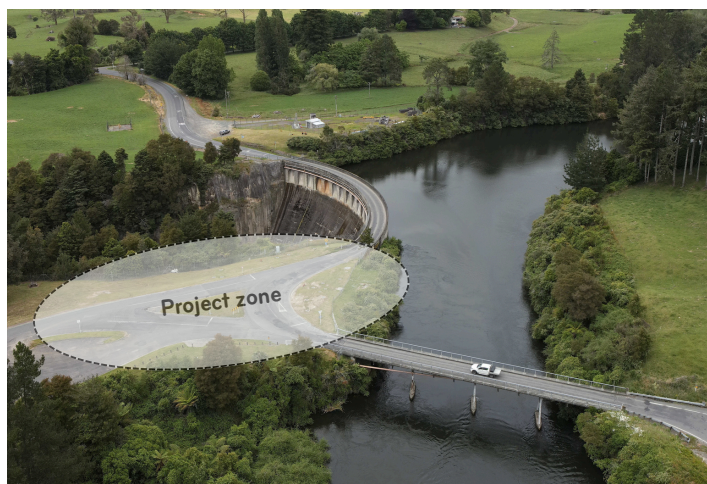



1:
The project team becoming familiar with the specialised rig for the jet grouting trial.

2:
The rig operating during its three-month deployment, helping to test our methods for consolidating the soils beneath the left abutment.

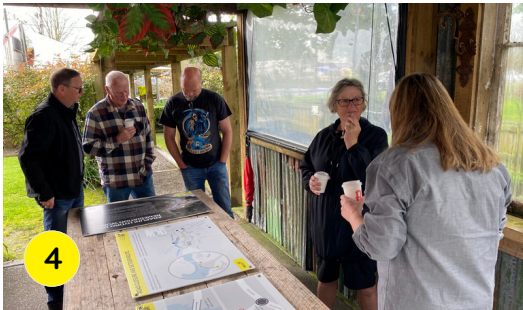

3:
The Mercury Board of Directors made a site visit to learn more about the jet grouting trial.

4:
We had some helpful, long conversations with people at our third community drop-in session at Rhubarb Cafe.



5:
Te Paea, Ramari and Levi (Ngaati Koroki Kahukura) were on traffic management duties during the jet grouting trial.

6:
Josh from Dam Watch and Kauri (Ngaati Koroki Kahukura) completing a water monitoring inspection at the dam.



7 & 8:
We ran a rescue exercise ahead of our relief drainage work at the bottom of the dam. It involved operating a "mule", a single-wheel stretcher, often used in emergency rescues where the terrain is difficult or access tracks are narrow.

✓ PROJECT UPDATE

JULY:

We established a new work site for our jet grouting trial. A rig was shipped from Hong Kong to use for the trial. Our iwi partners from Ngaati Koroki Kahukura joined the on-site project team to take charge of traffic management and help with environmental monitoring during the jet grouting trial.

AUGUST:

We continued with rock slope stabilisation on the left abutment and near walking tracks. This work will make it safe to work on relief drilling at the bottom of the dam. We also hosted the Mercury Board of Directors, who were keen to learn more about the project and meet our team.

SEPTEMBER:

We made great progress with our jet grouting trial work and the results began to provide a better picture

of the geology underneath the left abutment. Rock stabilisation work continued as well.

OCTOBER:

We held our third community drop-in session at the Rhubarb Cafe. Key discussions centred around the road closure across the dam in 2026 and our planning for the detour route; access to walkways and support for the cafe. We plan to hold our fourth drop-in early next year before we start the main works. We also completed the jet grouting trial.

NOVEMBER:

The project site was reset for the next phase of the early works; relief drainage at the bottom of the dam. A crane was used to deliver equipment to the bottom of the dam to kick-off the work. A helicopter will be delivering fuel and supplies for those working on the relief drainage once a week through to March 2025.





WHAT'S HAPPENING WITH THE ROAD CLOSURE?

- The main works is planned to start early to mid-2026 and will continue for about 18–36 months.
- To carry out works safely, the road across the dam will need to be closed.
- A detour route will be established along Powerhouse Road, this will be managed by traffic lights.
- Before work starts, Powerhouse Road will be improved to increase safety for all users.
- Road and traffic experts have reviewed the detour route's suitability, and we are working with South Waikato District Council and Waipā District Council to implement their recommendations.
- The detour route has limitations for High Productivity Motor Vehicles (HPMVs), such as large trucks that exceed maximum mass and length dimensions allowed for the temporary route.
- We are working with the freight industry to understand these impacts and plan suitable alternative routes.
- The western end of the swing bridge connecting to Powerhouse Road will be closed for safety.
- Access to the walking trails near Powerhouse Road will be restricted. The Waikato River Trail will remain open on the village side.
- We are exploring options to allow people walking or riding a bike to safely pass through the village and over the dam, avoiding the detour route.

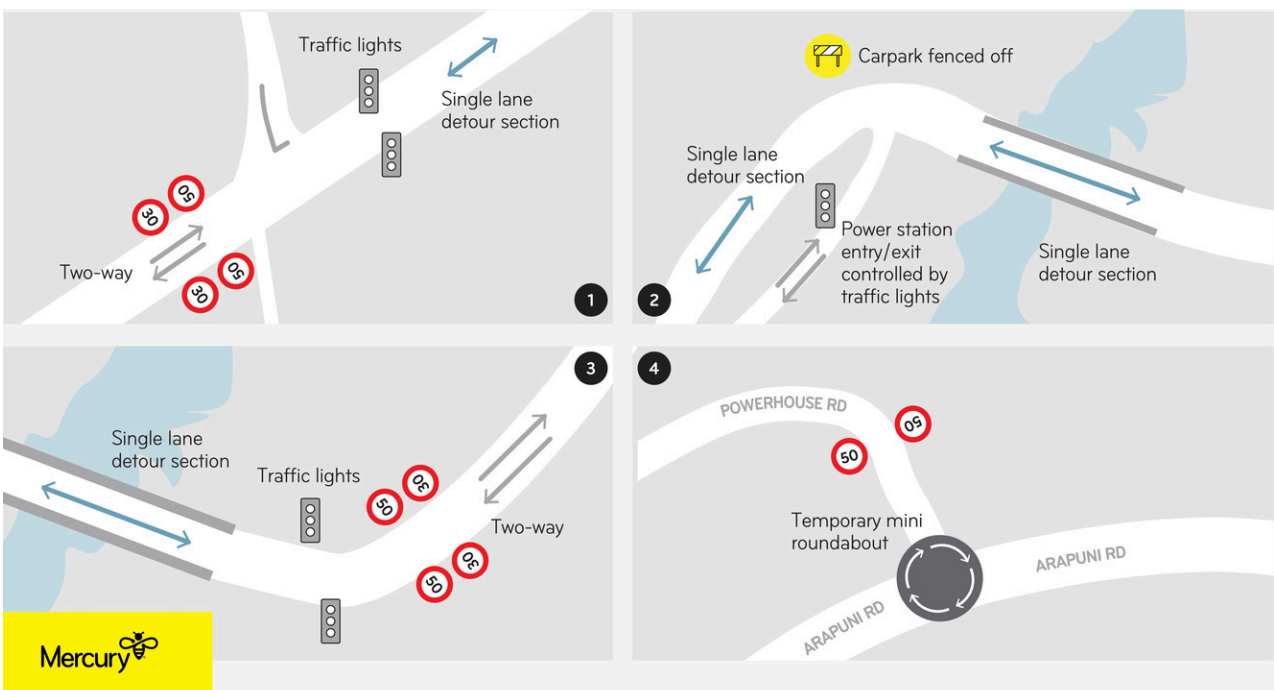
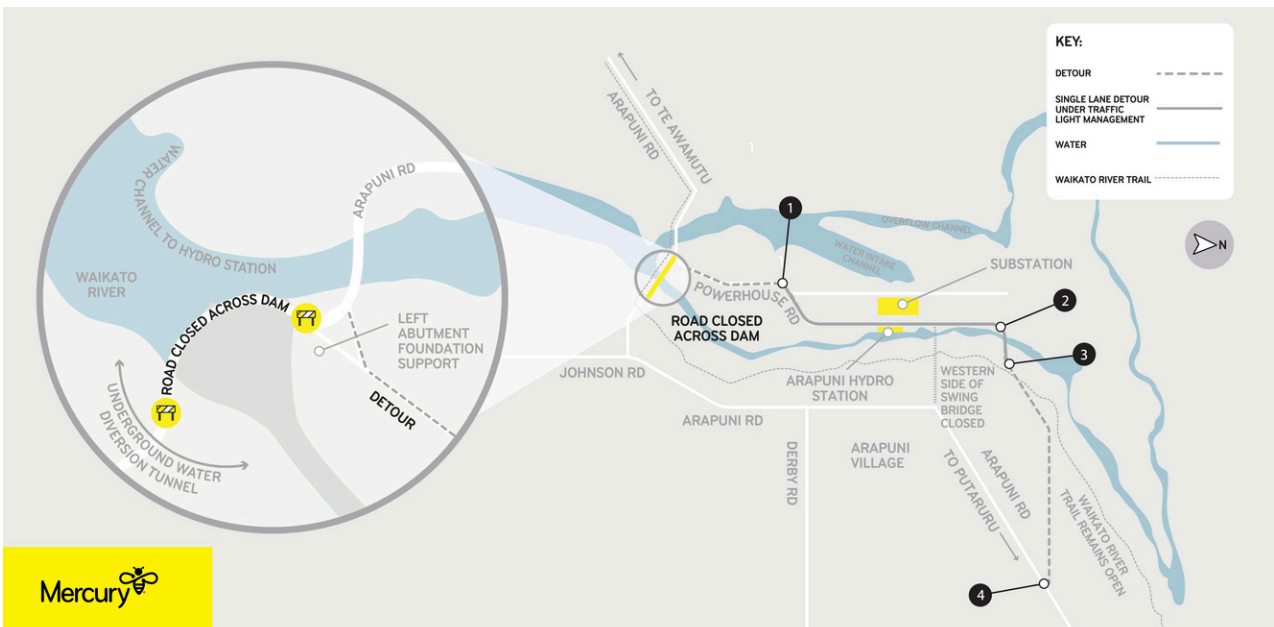

TIMELINE



PHASE 2 ENABLING WORKS.



**DECEMBER
2025**

- Submit business case for main works to Mercury's Board of Directors.



**JANUARY
2026**

- Relief drainage at the bottom of the dam continues to March 2026.



**FEBRUARY
2026**

- Anticipate upgrades to detour route start.

PHASE 3 CONSTRUCTION.



**APRIL 2026
ONWARDS**

- Main works project site set up. Anticipate dam road closure and temporary detour in place for 24-36 months.



HOW CAN I TALK TO THE PROJECT TEAM?

As the project progresses, we will continue to engage with stakeholders and local community to let people know what is planned. If you would like to contact the project team, or provide feedback, please email: project.arapuni@mercury.co.nz.

Scan the QR code or follow the link below to view our project webpage:

www.mercury.co.nz/arapuni-dam-remediation-work

